

SWINGFLEX DOOR MK6

There's a DMF solution to suit every doorway problem!

The MK6 selection is clearly your most flexible solution to a heavy duty impact door for openings used by motorised forklifts. Manufactured to your requirement, from cost effective modular componentry.

Swingflex® Model MK6

DOOR SELECTION.

Swingflex® door model MK6 is a heavy duty unit designed for motorised traffic. The recommended size range from 2400mm to 3600mm in height and 2000mm to 3000mm width. Higher openings can be accommodated by adopting a flexible transome flap above.

DOOR SELECTION.

The MK6 Swingflex® door handles motorised forklifts safely.

With the see through panels, drivers can foresee any danger right from their driving position. The PVC panel flexes on impact from the forklift or pallet load, the door opens, and the vehicle passes effectively through the opening.

FEATURES OF YOUR SWINGFLEX® DOOR.

- See through panels means safe two way traffic flow.
- Hands free operation, door opens with a gentle push and closes automatically behind you.
- Silent operation by flexible PVC panels absorbing any impact during opening and closing.
- Concealed spring controls, fully adjustable to suit your requirement.
- Doors are manufactured to clinical requirements as standard.
- Hold open controls are available if required.
- All PVC used is non toxic and contains no heavy base metals, such as cadmium, lead or barium.



SWINGFLEX DOOR MK6

There's a DMF solution to suit every doorway problem!

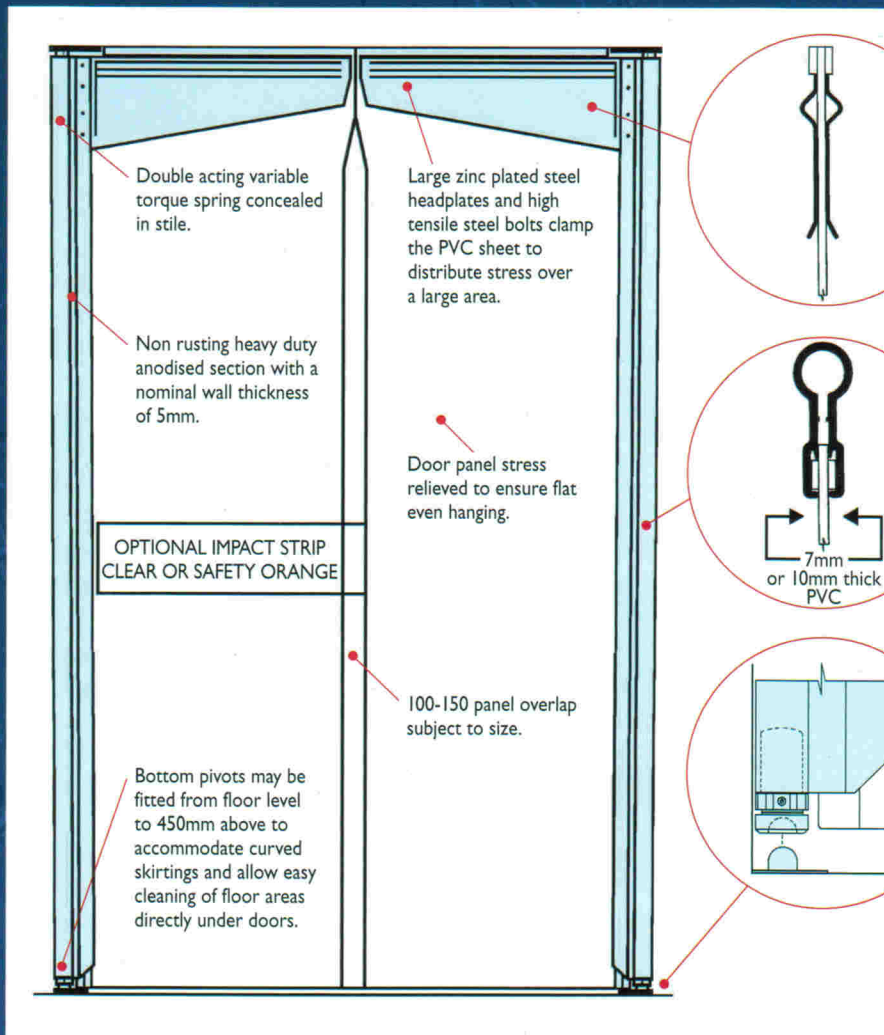

IMPORTANT DESIGN STANDARDS FOR ALL FLEXIBLE DOORS.

To enhance the life of any impact operated flexible doors it is strongly recommended that, where mechanical or hand operated traffic is used, door opening should be approximately 10% higher and 30% wider than the size of equipment passing through the opening.

FOR OPENINGS LARGER THAN STANDARD.

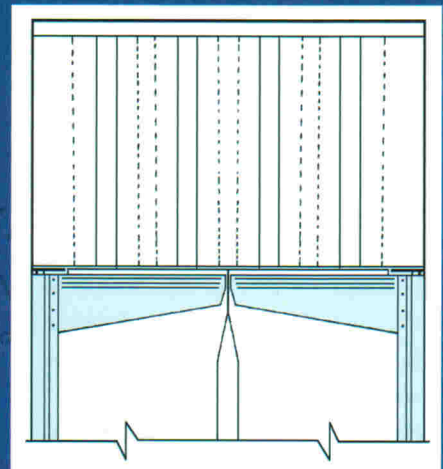

DESIGN FEATURES OF YOUR SWINGFLEX® DOOR MK6.

Heavy duty zinc plated steel head plates and high tensile steel bolts, clamp the PVC sheet to distribute the stress over a large area.

PVC retaining seams are integrally welding to the top edge, and sealed on top of the head plates to prevent any possible sagging of the PVC.

Also formed in the head plates is an anti-tear flair at the bottom edge and a projected forming to act as a skid bar on accidental impact.

Vertical stiles of strong extruded aluminium section, and anodised for extra protection and appearances. The PVC sheet, either 7mm or 10mm in thickness, is held in place by two full length welded seams captivated in the extruded stile.

The unique hemispherical bottom support pivot enables easy installation. Even with misaligned floors or door jambs, it guarantees effortless opening. The adjustable jack located in the stile is used to correct the door height after installation.

Door openings with a height in excess of 3000mm, transome flaps can be fitted above the doors. Where the width exceeds 3000mm wide, a dual spring model is recommended.



Head Office and Manufacturing Plant
3/88 Magowar Road, Girraween NSW 2145 Australia
Tel. +61 2 9636 5466 Fax. +61 2 9688 1531
Agents in all Australian States, New Zealand, Singapore, Philippines,
Malaysia, Hong Kong, Indonesia, Sth Korea, China and India.

Your local distributor:

ASA FLEXIBLE DOORS
PTY LTD

PH 9248 1055 MALAGA WA